

# EXPLODED VIEW

ITEM NO.	QTY.	PART NO.	DESCRIPTION	LENGTH
1	2	TOP_BOTTOM	3/4" PLYWOOD	32" x 16"
2	2	B	2x4	22"
3	2	A	2x6	22"
4	2	SIDE	3/4" PLYWOOD	32" x 22 1/2"
5	4	C	2x4	22 1/2"
6	4	E	2x4	8"
7	5	D	2x4	14 1/2"
8	2	END	3/4" PLYWOOD	24" x 16"
9	2	F	2x4	16"
14	1	Model A Engine Block	FORD PART	
15	2	Model A Cyl Head Nut	FORD PART	
16	2	Model A Cyl Head Stud	FORD PART	
17	1	Model A Flywheel	FORD PART	

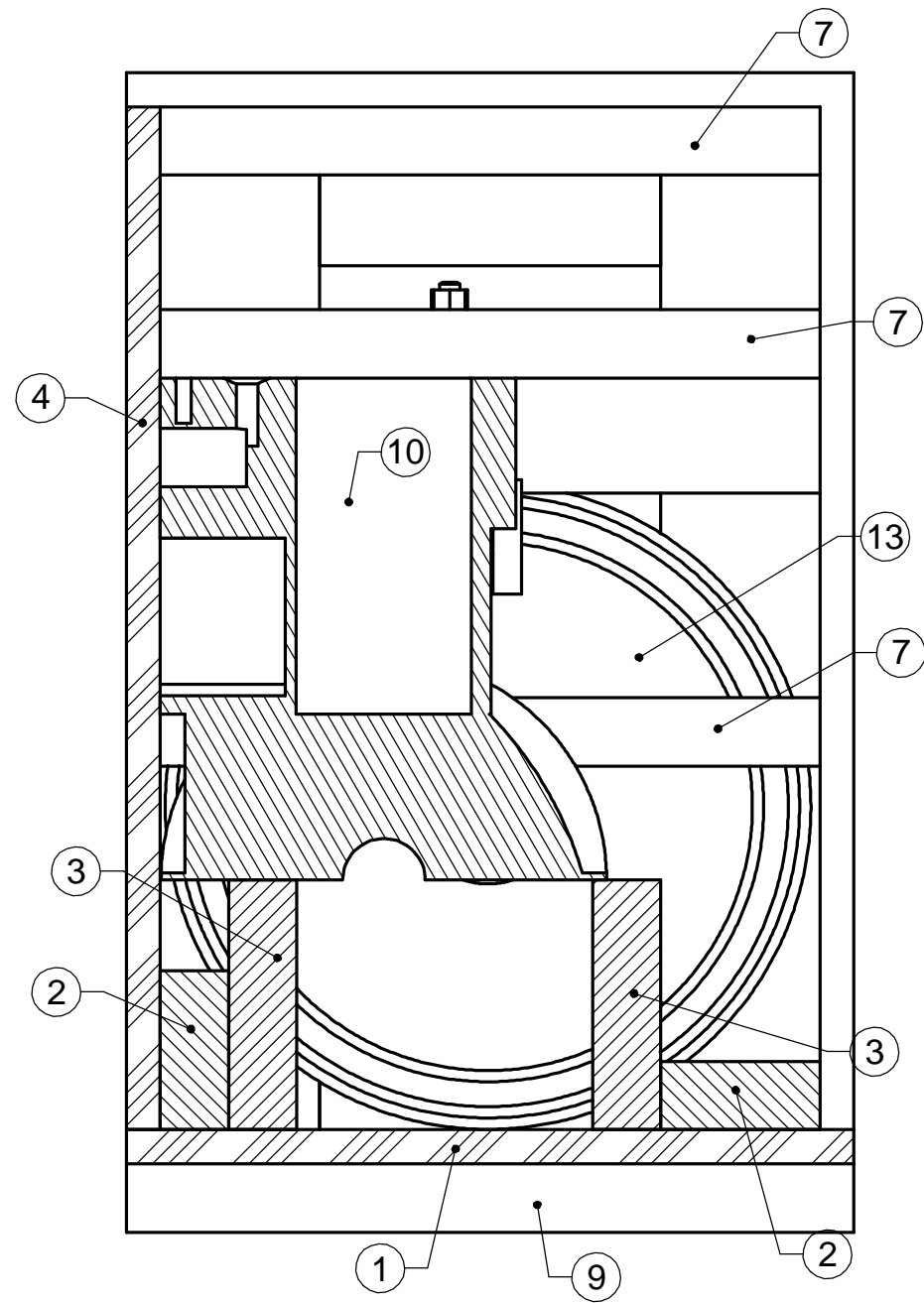

SECTION A-A

ITEM NO.	QTY.	PART NO.	DESCRIPTION	LENGTH
1	2	TOP_BOTTOM	3/4" PLYWOOD	32" x 16"
2	2	B	2x4	22"
3	2	A	2x6	22"
4	2	SIDE	3/4" PLYWOOD	32" x 22 1/2"
5	4	C	2x4	22 1/2"
6	4	E	2x4	8"
7	5	D	2x4	14 1/2"
8	2	END	3/4" PLYWOOD	24" x 16"
9	2	F	2x4	16"
10	1	Model A Engine Block	FORD PART	
11	2	Model A Cyl Head Nut	FORD PART	
12	2	Model A Cyl Head Stud	FORD PART	
13	1	Model A Flywheel	FORD PART	

E (8.0)	E (8.0)	E (8.0)	E (8.0)	B (22.0)	B (22.0)	D (14.5)	SCRAP
---------	---------	---------	---------	----------	----------	----------	-------

D (14.5)	D (14.5)	D (14.5)	D (14.5)	SCRAP			
----------	----------	----------	----------	-------	--	--	--

C (22.5)	C (22.5)	C (22.5)	C (22.5)	C (22.5)	SCRAP
----------	----------	----------	----------	----------	-------

A (22.0)	A (22.0)	SCRAP				
----------	----------	-------	--	--	--	--

2"x6"x8' (OTHER THREE ARE 2x4x8')

16.0" x 32.0"  
ITEM #1  
TOP\_BOTTOM

16.0" x 32.0"  
ITEM #1  
TOP\_BOTTOM

16.0" x 24.0"  
ITEM # 8  
END

22.5" x 32.0"  
ITEM # 4  
SIDE

22.5" x 32.0"  
ITEM # 4  
SIDE

16.0" x 24.0"  
ITEM # 8  
END

4' x 8' SHEET OF 3/4" THICK PLYWOOD

